

FTA 5180 Quick Reference Guide

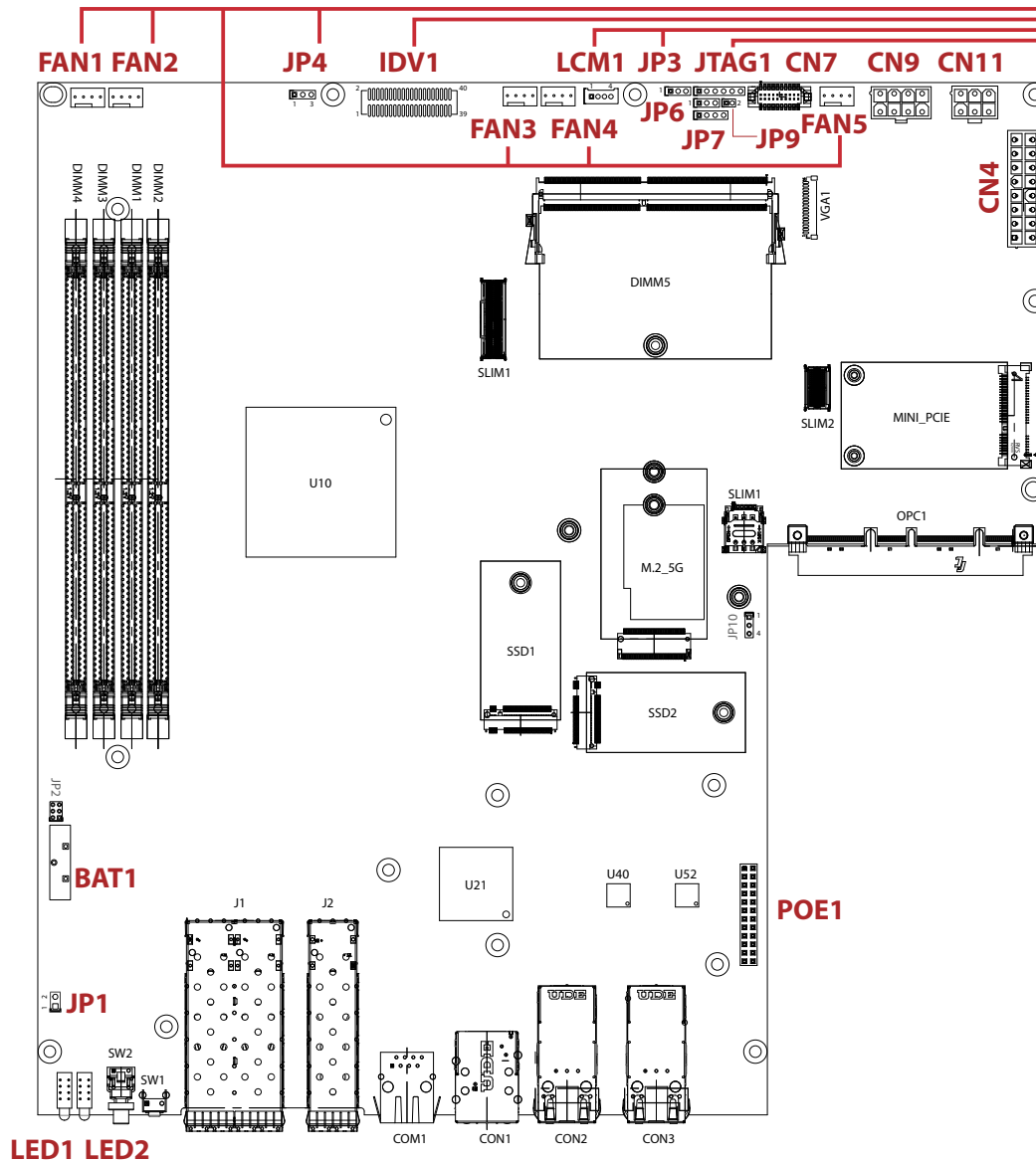

FAN1, FAN2, FAN3, FAN4, FAN5 : FAN Wafer Conn.

Pin	Description
1	GND
2	P12V
3	TACH
4	PWM

JP4 : PWM Controller SMBUS Header

Pin	Description
1	SMB_DATA
2	SMB_CLK
3	GND

IDV1: IDV Connector

Pin	Signal	Pin	Signal
1	P3V3_RTC_AUX	2	PWRGD_P3V3_AUX
3	RST_RTCRST_N	4	PWRGD_CPU_LVC3_PLD_R3
5	P3V3_SOC	6	GND
7	P1V8_AUX	8	P1V05
9	PVNN_NAC	10	IDV_RST_PLTRST_N
11	P1V05_NAC	12	PVNN_PCH
13	RST_RSMRST_PCH_N	14	PWRGD_PVCCIN_CPU
15	FM_CPU_MSMT_LVT3_R_N	16	GND
17	P1V2_VDDQ	18	PWRGD_PCH_PWROK
19	NC	20	PVCCIN_CPU
21	PWRGD_PVNN_NAC	22	P2V5_PVPP
23	NC	24	FM_CPU_ERR2_LVT3_N
25	FM_CPU_CATERR_LVT3_R_N	26	GND
27	FM_CPU_PROCHOT_LATCH_LVT3_R_N	28	FM_CPU_ERR1_LVT3_N
29	FM_CPU_THERMTRIP_LATCH_LVT3_R_N	30	FM_CPU_ERR0_LVT3_N
31	PWRGD_DRAMPWRGD_R2	32	PVTT
33	PWRGD_PS_PWROK_IDV	34	FM_SLPS3_N
35	FM_SLPS4_N	36	GND
37	SMB_SMLINK0_STBY_LVC3_MITL_SDA	38	SMB_SMLINK0_STBY_LVC3_SCL
39	PECI_CPU_PCH_BMC_R1	40	IDV_PWR_BUTTON_N

LCM1 : LCM (Reserved)

Pin	Description
1	PWR_LCM
2	SP_LCM_TXD
3	SP_LCM_RXD
4	GND

JP3 : RTC Clear

Pin	Description
1	NC
2	RST_RTCRST_N
3	GND

JTAG1 : LCM (Reserved)

Pin	Description
1	P3V3_CPLD
2	GND
3	JTAG_TCK_CPLD
4	JTAG_TDO_CPLD
5	JTAG_TDI_CPLD
6	JTAG_TMS_CPLD

FTA 5180 Quick Reference Guide

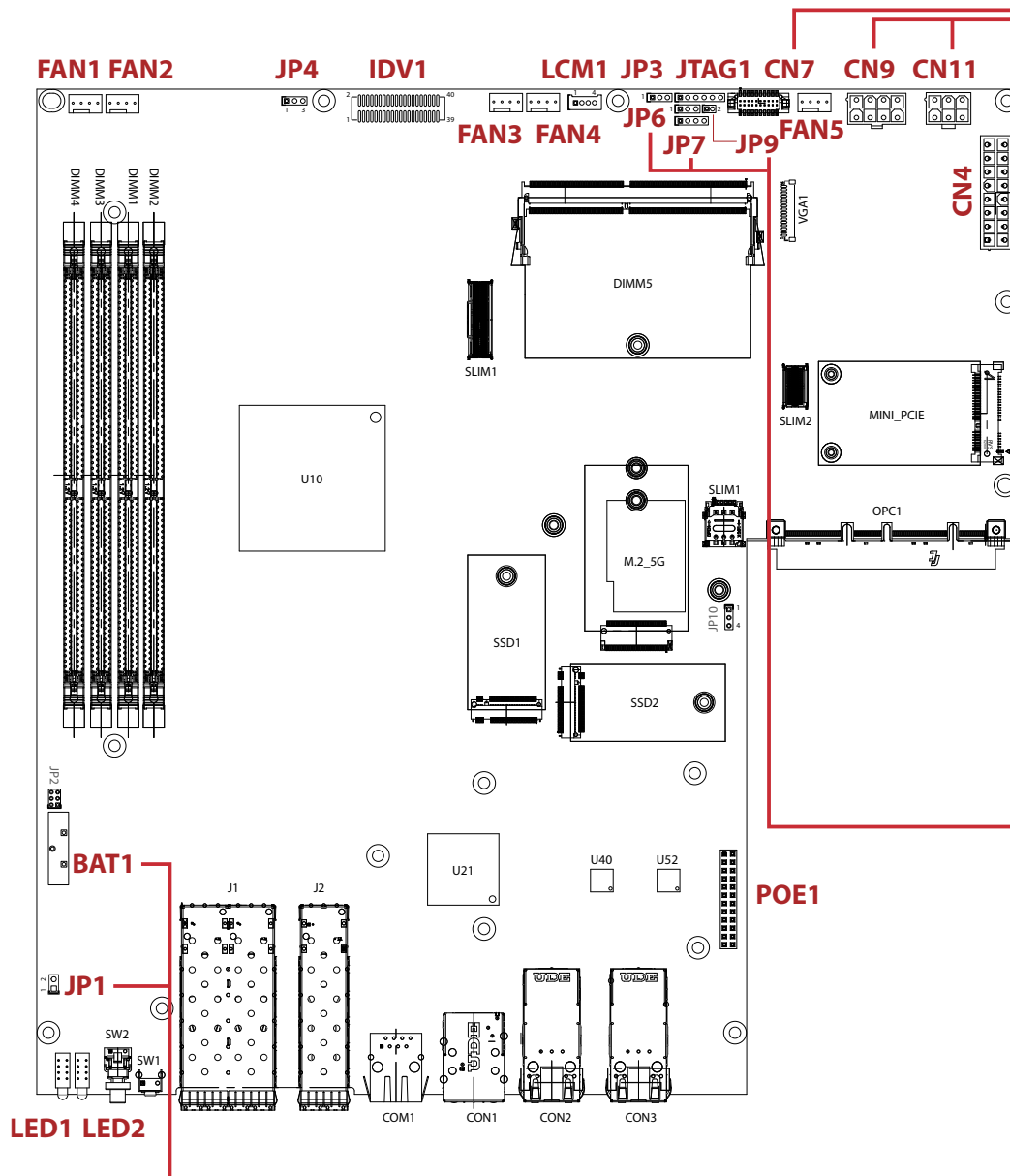

CN7 : Power Signal to Power Supply

Pin	Description	Pin	Description
1	NC	2	SMB-ALERT_A_CAB
3	NC	4	SMB-ALERT_B_CAB
5	SMB_PMBUS1_STBY_LVC3_R_SCL	6	PRESENT_IN_A_CAB
7	SMB_PMBUS1_STBY_LVC3_R_SDA	8	PRESENT_IN_B_CAB
9	NC	10	GND
11	PS_ON_R	12	P3V3_AUX
13	NC	14	P3V3_AUX
15	PW_OK_A_CAB	16	GND
17	PW_OK_B_CAB	18	NC
19	NC	20	NC

CN9 : Internal Power Conn.

Pin	Description
1	GND
2	GND
3	GND
4	GND
5	P12V
6	P12V
7	P12V
8	P12V

CN11 : Internal Power Conn.

Pin	Description
1	GND
2	GND
3	GND
4	P12V
5	P12V
6	P12V

CN4 : Internal Power Conn.

Pin	Signal	Pin	Signal	Pin	Signal
1	P12V_AUX	7	P12V_AUX	13	GND
2	P12V_AUX	8	P5V_STBY	14	GND
3	P12V_AUX	9	GND	15	GND
4	P12V_AUX	10	GND	16	GND
5	P12V_AUX	11	GND		
6	P12V_AUX	12	GND		

JP6 : UART From CPLD

Pin	Description
1	PLD_PR20C
2	GND
3	PLD_PR20D

JP9 : BMC UART Debug

Pin	Description
1	JTAG_SEL
2	GND

JP7 : BMC UART Debug

Pin	Description
1	P3V3_BMC
2	BMC_CPLD_DEBUG_RXD
3	BMC_CPLD_DEBUG_TXD
4	GND

BAT1 : SYS RTC Holder

Pin	Description
1	RTC_BAT
2	RTC_BAT
3	GND

JP1 : System Power Button Header

Pin	Description
1	IDV_PWR_BUTTON_N
2	GND

FTA 5180 Quick Reference Guide

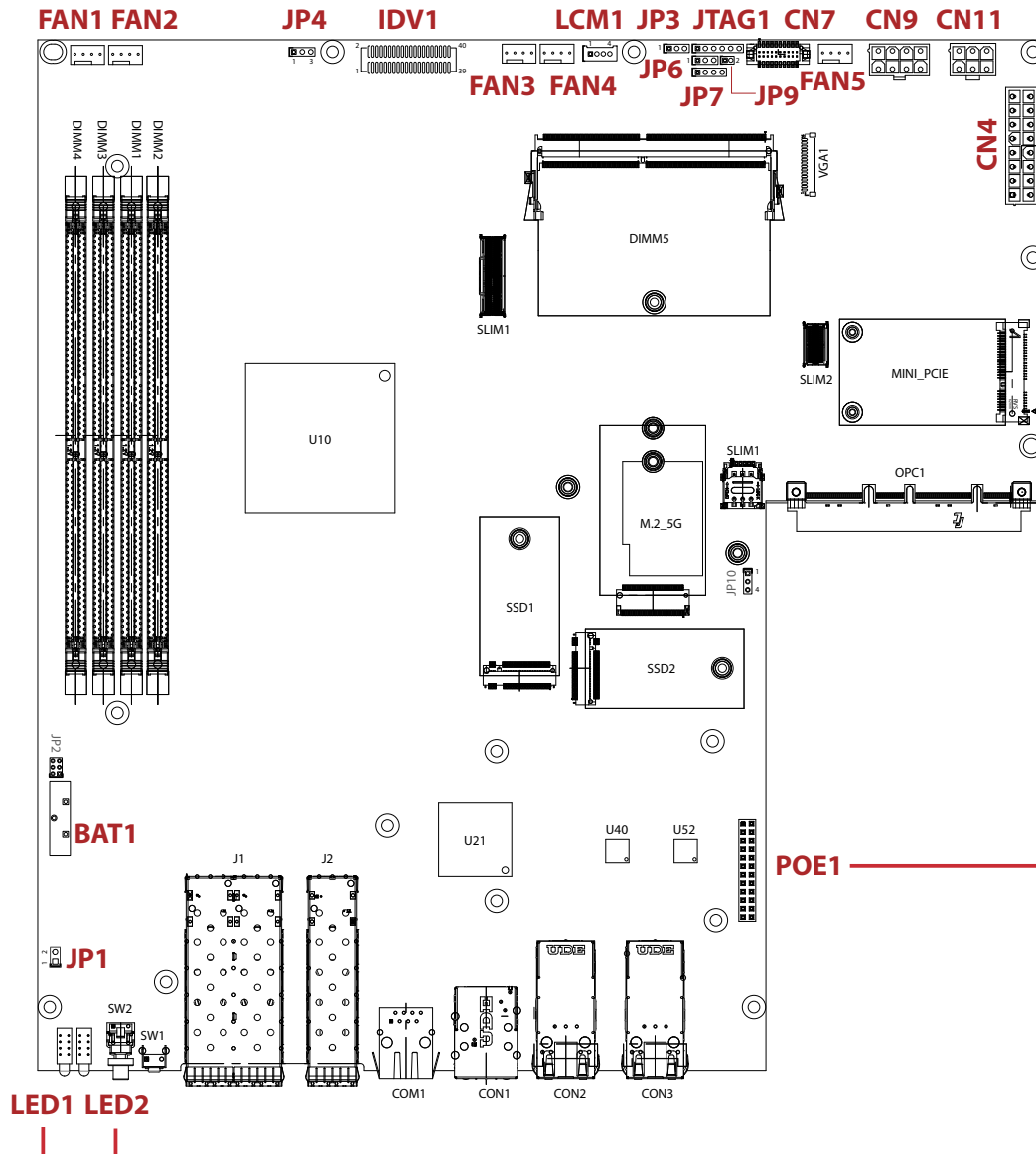

POE1 : POE Header

Pin	Description	Pin	Description
1	POE_LED1	2	POE_LED2
3	POE_LED3	4	POE_LED4
5	GND	6	P3V3
7	SMB_DAT_POE_R	8	POE_INT_N
9	SMB_CLK_POE_R	10	POE_RST_N
11	GND	12	NC
13	POE MAIN POK	14	VPORT_NEG_10G_OUT4
15	P54V	16	VPORT_NEG_10G_OUT3
17	P54V	18	VPORT_NEG_10G_OUT2
19	P54V	20	VPORT_NEG_10G_OUT1
21	VPORT_NEG_10G_OUT8	22	VPORT_NEG_10G_OUT5
23	VPORT_NEG_10G_OUT7	24	VPORT_NEG_10G_OUT6

LED1 : Power LED

Pin	Net
1	CPLD_PWR_LED
2	CPLD_HDD_LED
3	SW_SYS_LED
4	CPLD_GPIO1_LED

LED2 : POE LED

Pin	Net
1	POE_LED1
2	POE_LED2
3	POE_LED3
4	POE_LED4